

CRUSE & ASSOCIATES

PROFESSIONAL LAND SURVEYORS



MAHRE BLA DESCRIPTIONS 7/30/12

Revised 17-19-33020-0009

Part of the East 1/2 of the Northwest 1/4 of Section 33, which is described as follows:

Beginning at the center North 1/16 section corner and running South on the quarter section line 286 feet; thence West 57.3 feet to the East line of the County Road; thence North $34^{\circ}38'$ West along said West line 668.3 feet; thence East 437.2 feet to a point on the quarter section line; thence South on said quarter section line 264 feet to the point of beginning;

AND

That portion of the Northwest 1/4 of the Northeast 1/4 of Section 33 bounded by a line described as follow:

Beginning at the center north 1/16 section corner, which is the true point of beginning for said described line, and running thence North on the quarter section line 264 feet; thence East to the northwesterly right of way line of the Cascade Canal; thence southwesterly along said northwesterly right of way line to its intersection with the south line of said Northwest 1/4 of the Northeast 1/4; thence west along said south line to the true point of beginning for said described line;

All in Township 17 North, Range 19 East, W.M., in the County of Kittitas, State of Washington.



CRUSE & ASSOCIATES

PROFESSIONAL LAND SURVEYORS



MAHRE BLA DESCRIPTIONS (cont.)
7/30/12

Revised 17-19-33010-0004

That portion of the Northwest 1/4 of the Northeast 1/4 of Section 33, which is described as follows:

A tract of land bounded by a line beginning at the Northwest corner of said quarter of quarter section and running thence East 512 feet; thence South 1000 feet, more or less, to the North right of way line of the Cascade Canal; thence westerly and southwesterly along said North right of way line to its intersection with the West line of the Northeast 1/4 of said Section 33; thence North along said west line to the point of beginning;

EXCEPT that portion lying northerly of the south right of way of Orchard Road;

AND EXCEPT That portion of the Northwest 1/4 of the Northeast 1/4 of Section 33 bounded by a line described as follow:

Beginning at the center north 1/16 section corner, which is the true point of beginning for said described line, and running thence North on the quarter section line 264 feet; thence East to the northwesterly right of way line of the Cascade Canal; thence southwesterly along said northwesterly right of way line to its intersection with the south line of said Northwest 1/4 of the Northeast 1/4; thence west along said south line to the true point of beginning for said described line;

All in Township 17 North, Range 19 East, W.M., in the County of Kittitas, State of Washington.

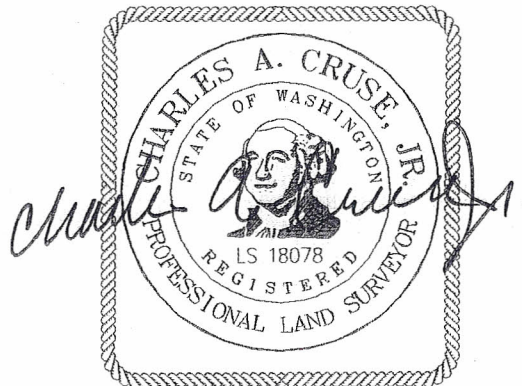

7-30-12



RECEIVED

JUL 30 2012

KITTITAS COUNTY
CDS

EXISTING

EXHIBIT "A"

That portion of the Southeast 1/4 of the Southwest 1/4 of Section 28, which is described as follows:

A tract of land bounded by a line beginning at the Southeast corner of said quarter of quarter section, and running thence North along the East boundary line of said quarter of quarter section 406 feet; thence West to the East boundary line of the right of way of the canal of the Ellensburg Water Company; thence southwesterly, westerly, and northwesterly along the boundary line of said canal to its intersection with a line which is 579.5 feet West and parallel with the East line of said Southeast 1/4 of the Southwest 1/4; thence South along said parallel line to the South line of said subdivision; thence East along said South line to the point of beginning.

That portion of the Southwest 1/4 of the Southeast 1/4 of Section 28, which is described as follows:

A tract of land bounded by a line beginning at the Southwest corner of said quarter of quarter section, and running thence East 512 feet; thence North to the right of way of the canal of the Ellensburg Water Company; thence westerly along the South bank of the canal of the Ellensburg Water Company to the West boundary line of said quarter of quarter section; and thence South to the point of beginning.

That portion of the Northeast 1/4 of the Northwest 1/4 of Section 33, which is described as follows:

A tract of land bounded by a line beginning at the Northeast corner of said quarter of quarter section, and running thence West 579.5 feet; thence South 407.5 feet; thence West 52 feet; thence South 665.5 feet; thence East 651.5 feet to the East boundary line of said quarter of quarter section; and thence North on said East boundary line 1073 feet to the point of beginning.

EXCEPT: A tract of land beginning 472.7 feet West of a point 264 feet North of the Center North 1/16 section corner in said Section 33; thence running West 170 feet; thence North 252 feet; thence South 34° East along the West line of the County Road 304 feet to the point of beginning.

That portion of the Northwest 1/4 of the Northeast 1/4 of Section 33, which is described as follows:

A tract of land bounded by a line beginning at the Northwest corner of said quarter of quarter section and running thence East 512 feet; thence South 1000 feet, more or less, to the North right of way line of the Cascade Canal; thence westerly and southwesterly along said North right of way line to its intersection with the West line of the Northeast 1/4 of said Section 33; thence North along said West line to the point of beginning.

Part of the East 1/2 of the Northwest 1/4 of Section 33, which is described as follows:

Beginning at the center North 1/16 section corner and running South on the quarter section line 236 feet; thence West 57.3 feet to the East line of the County Road; thence North 34°38' West along said West line 668.3 feet; thence East 437.2 feet to a point on the quarter section line; thence South on said quarter section line 264 feet to the point of beginning.

ALL in Township 17 North, Range 19 East, W.M., in the County of Kittitas, State of Washington.

B

A